

LOC. REV.	DESCRIPTION	ECO. NO.	DWGT. (CHK/APP)	DATE
01	RELEASE FOR QUOTE/ FOR PURCHASE	73-00133	JPP/JC	MD 5-24-07
02	ITEM 5 WAS ASY000272-000	73-001501	JPP/JCS	J 9-26-07
1)	ITEM 23 WAS 533897			
2)	ITEM 24 WAS 57404			
3)	ITEM 27 WAS 530825			
4)	ITEM 32 WAS LIT000092-000	73-001801	JPP/JC	MD 02-12-08
5)	ITEM 36 WAS 70784			
6)	ITEM 42 QTY. WAS 3; 7) UPDATE NOTES			
8)	RELEASE FOR PURCHASE/SAMPLE BUILD			

REVISIONS

PLACE ROHS CONFORM LABEL ON INPUT PANEL

PART OF LIT. PACKAGE #23

PACKAGING NOTES

1. FINAL ASSEMBLY TO BE PACKAGED IN ITEMS: 25,28,29 & 40 PER PACKING SPEC PA-029
2. ITEMS TO BE PACKAGED: 23,30,31,33,39
3. LABELS CONTAINED IN THE FA ROHS COMPLIANT LABELING PKG SHOULD BE AFFIXED BY THE FOLLOWING: THE CARTON LABEL, SHIPPING LABEL AND ROHS COMPLIANT LABEL SHOULD BE AFFIXED TO THE CARTON. THE ROHS CONFORM LABEL SHOULD BE AFFIXED TO THE INPUT PANEL.
4. DO NOT ALLOW LOCITTE (ITEM 22) TO CONTACT THE HORNS (ITEMS 4 AND 6) BECAUSE THE LOCITTE WILL DISSOLVE THE PLASTIC.
5. THE ELECTRICAL TERMINALS ON THE WOOFERS ARE FRAGILE. SUPPORT THE WOOFER TERMINAL WHILE SLIDING ON THE WIRE CONNECTOR.

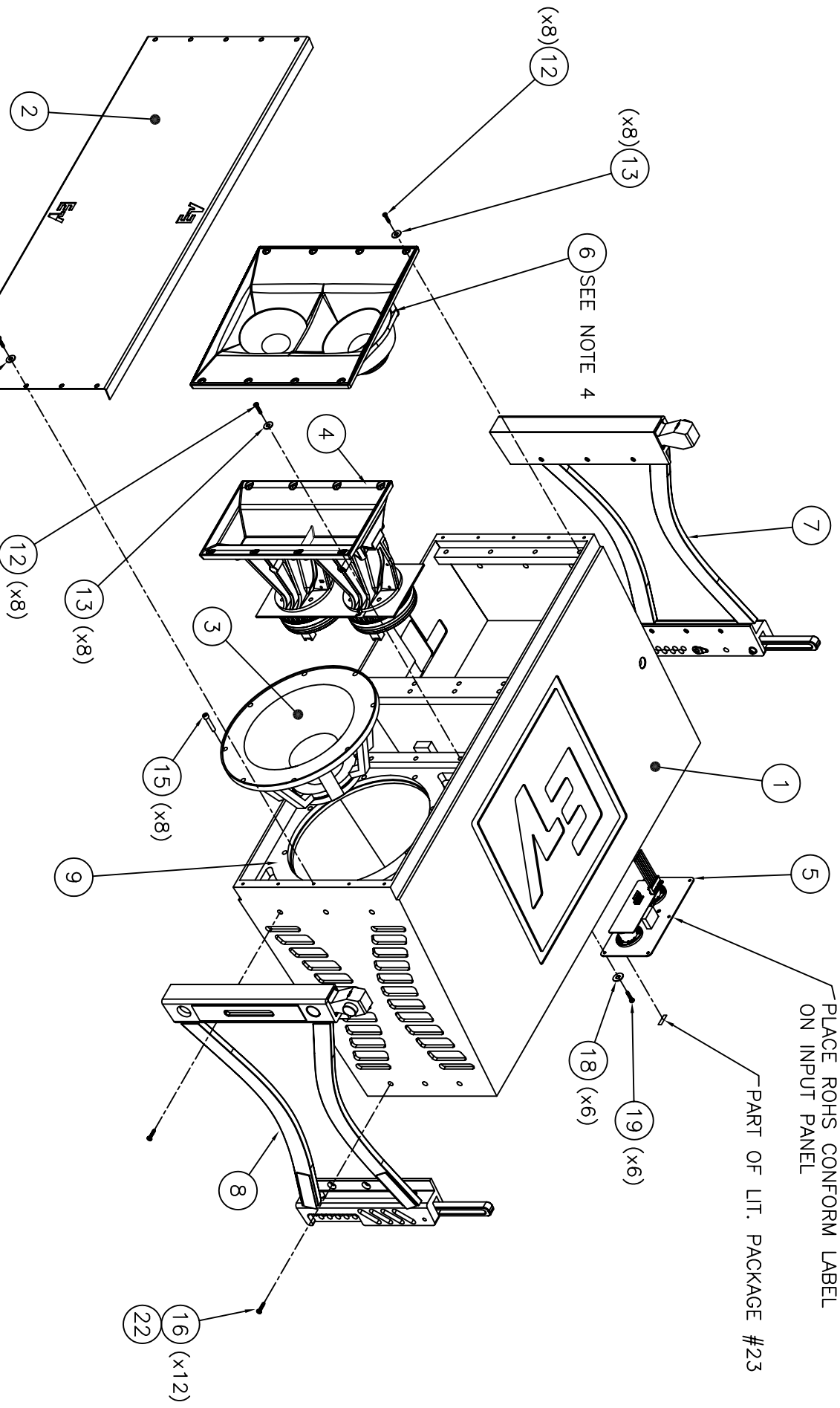

36.225±.040

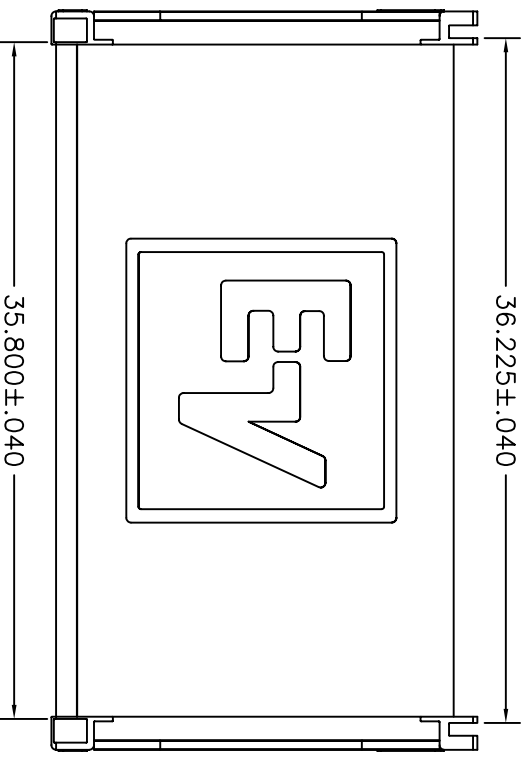

TOLERANCE DETAIL

- NOTES:
1. ALL TOLERANCES SHOWN AFTER RIGGING HAS BEEN INSTALLED.
  2. BOTH DIMENSIONS REFLECT WIDTH OF ENCLOSURE (WITH EV COAT FINISH) AND RIGGING.

BILL OF MATERIALS FOR ONE COMPLETE UNIT

ITEM	PART NUMBER	QTY.	MATL	DESCRIPTION	SIZE
42	CME000140030	1	----	FOAM, WIRE SEAL, 1.5 X 1.5 X 3.0	
41	20655	10	----	INSERT, 8-32, THREADED, STAFEST #D83220	
40	500277-024	2	----	PAD, PACKAGING, XLC	
39	38110-174	REF	----	CEC (XLC SERIES)	
38	11648	AR	----	COATING, BLK, WATER PROOFING GP MOYEN WS-1044H	
37	FS1000012-000	AR	----	STAPLE, CHISEL POINT, 1/2" CROWN X 3/8" LONG, DUOFASST #35508	
36	97498	AR	----	ADH, CAULK, BLK VINYL, GLOUCESTER "PHENOSEAL"	
34	----	----	----	----	
33	SPC000069-000	REF	----	ENGINEERING/QC TEST SPECIFICATION, XLC907DX & XLC907DVX	
32	----	----	----	----	
31	LIT000018-000	REF	----	SDS (XLC127DVX)	
30	38110-145	1	----	RIGGING MANUAL (XLC SERIES)	
29	576135-007	2	----	DIE CUT TRAY, PACKAGING, XLC127	
28	576134-019	1	----	CARTON, PACKAGING, XLC127	
27	T-2093	REF	----	PROCESS SPECIFICATION, LOUDSPEAKER ASSEMBLY TORQUE SPEC	
26	591621-000	11/8 LF	----	BATTING, COTTON, BLUE, 12-IN W X 2-IN THK X 25 FEET LONG	
25	576199-000	1	----	34 X 20 X 60 POLY BAG 2.5 MIL	
24	LLA000184000	1	----	FA, ROHS COMPLIANT, LABELING PKG	
23	LIT000138010	1	----	XLC/XLCI 907 DVX LITERATURE PKG	
22	97207	50	GRAM	LOCITTE "C" 24231	BTL
21	63054-CP	4	----	SCR, 8-15 X 5/8, PAN HD, XREG, TYPE AB, STL	
20	73413	4	----	TIE, CABLE, NYLON, 6.25" LG, #8 SCR MFG, AMP# 2-608693-0	
19	581007-000	6	----	SCR, 8-15 X 3/4, TRS HD, X-REG, STL, STL, BLK OX	
18	38865	6	----	WASHER, .171 X .375 X .062T, FLAT, NYLON, BLK	
17	63409-MBX	10	----	SCR, 8-32 X 3/4, TRS HD, XREG, STN STL, BLK OX	
16	63136-AH	12	----	SCR, 5/16-18 X 1-1/4, FLT HD, SRT, CAP, GRD/8, BLK E-COAT	
15	581004-000	8	----	SCR, 1/4-20 X 1.25, HEX SRT HD, CAP, STN STL, BLK OXIDE	
14	588020-063	7.5FT	----	TAPE, FOAM TAPE, 1/2" WIDE, .063" THICK, VINYL/NEOPRENE, CLOSED-C	
13	38809	26	----	WASHER, .188 X .500 X .063T, FLT, BLK NYLON	
12	581003-000	16	----	SCR, 10-24 X 1, PAN HD, XREG, STN STL, BLK OXIDE	
11	570197-000	1	----	LABEL, SCRIBBLE, XLC	
10	570196-000	1	----	LABEL, RIGGING WARNING, XLC	
9	701910012	1	----	GASKET, 12" WOOFER GASKET FOAM TAPE, 1/2" WIDE, .063" THICK, RIGGING S/A, XLC-127, RIGHT	
8	560158-000	1	----	RIGGING S/A, XLC-127, LEFT	
7	560157-000	1	----	RIGGING S/A, XLC-127, LEFT	
6	ASY000037-000	1	----	MIDBASS ASSY, XLC-DVX	
5	ASY000337-003	1	----	INPUT PANEL S/A, XLC907DX, WITH WIRING HARNESS	
4	ASY0002271-000	1	----	HIGH FREQUENCY S/A, XLC907DVX	
3	302034-001	1	----	DVX3121, WOOFER 12", SYSTEMS, NO PKG	
2	800761-000	1	----	GRILLE S/A, XLC-127	
1	800758-001	1	----	ENCLOSURE S/A, XLC-127, BLK FUTURA	

CAD SYSTEM: AUTOCAD

MODEL	NEXT ASSY
XLC907DX	-----

UNSPECIFIED LIMITS OF TOLERANCE  
 FINISHES: .005 IN/.75 IN, X ±.030 IN,  
 CONCENTRICITY .010 TH, XX ±.030 IN,  
 ANGLES ±1/2 DEGS ±Z  
 UNMARKED ANGLES: BEZES  
 AND INTERSECTIONS: 80°  
 FINISHES: INT. CLASS 2A  
 THREDS: INT. CLASS 2A  
 MOLD FINISH: DRAFT 2°  
 MACHINED FINISH: #4

DR JPP [OK] JC APP MD  
 DATE 05-23-07/SCALE NONE  
 DO NOT SCALE DRAWING

**TELEX**

FINAL ASSY  
 XLC907DVX  
 P/N PRD000099-001  
 SIZE DWG. NO. PRD000099  
 D SH. 1 OF 3  
 PLANT DIST. MO

A

B

C

D

A

B

C

D